

OPTIMA PALLET RACK/KUORMALAVAHYLLY/PALLSTÄLL/KAUBAALUSE RIIUL ASSEMBLY INSTRUCTION

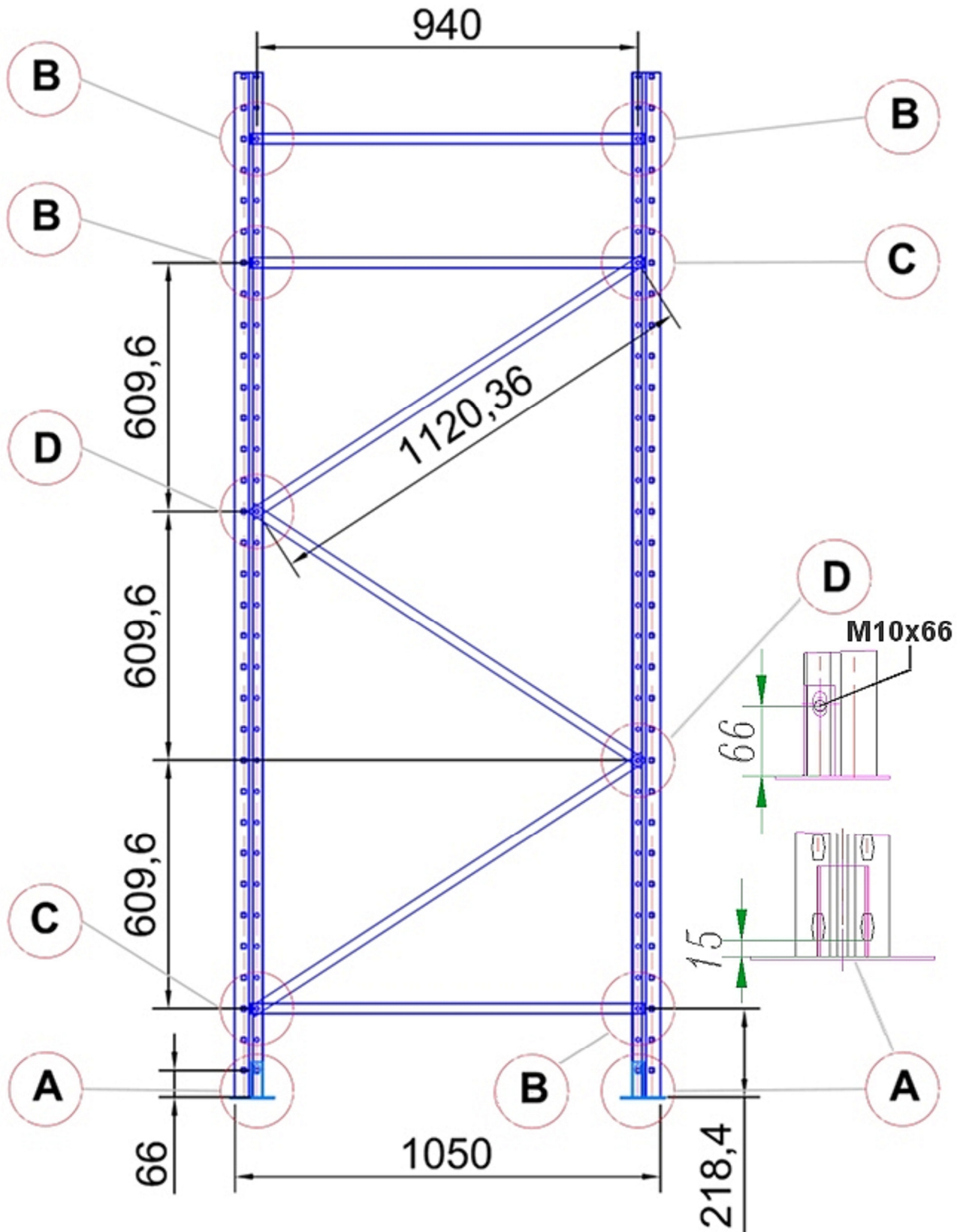

A



B



C

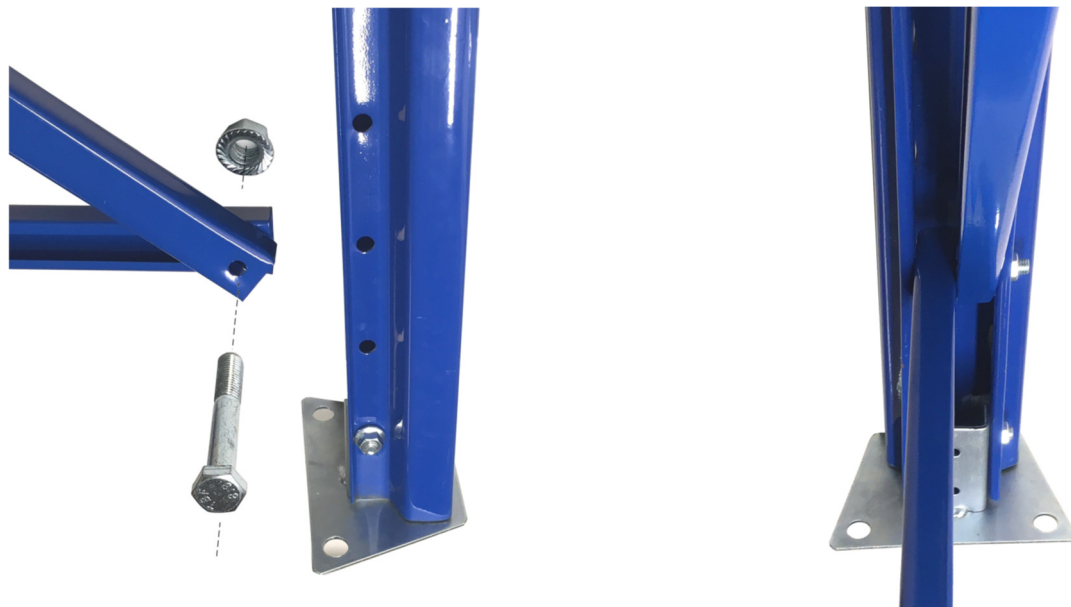

D



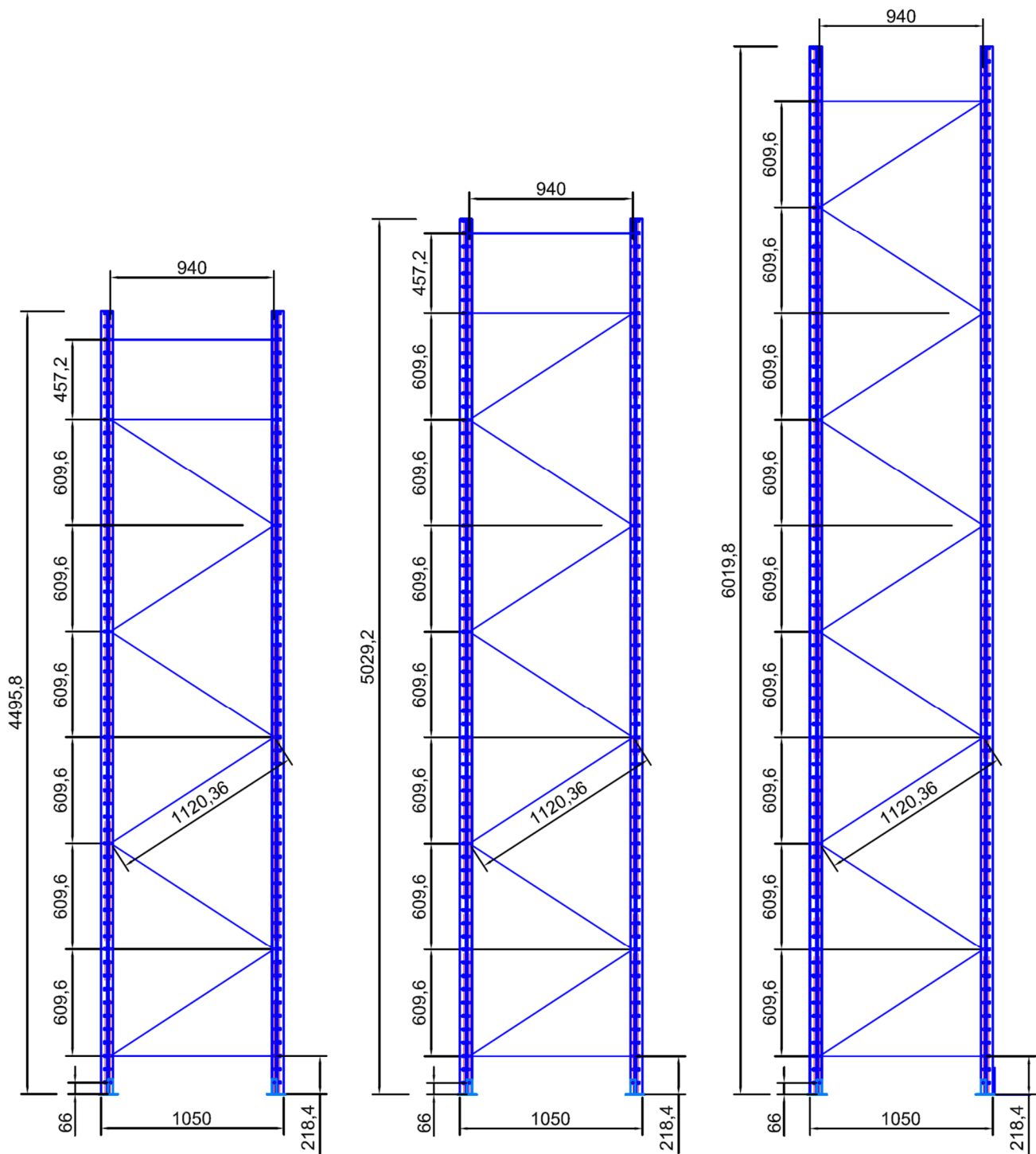

3 H + 6 D

3 H + 7 D

2 H + 9 D

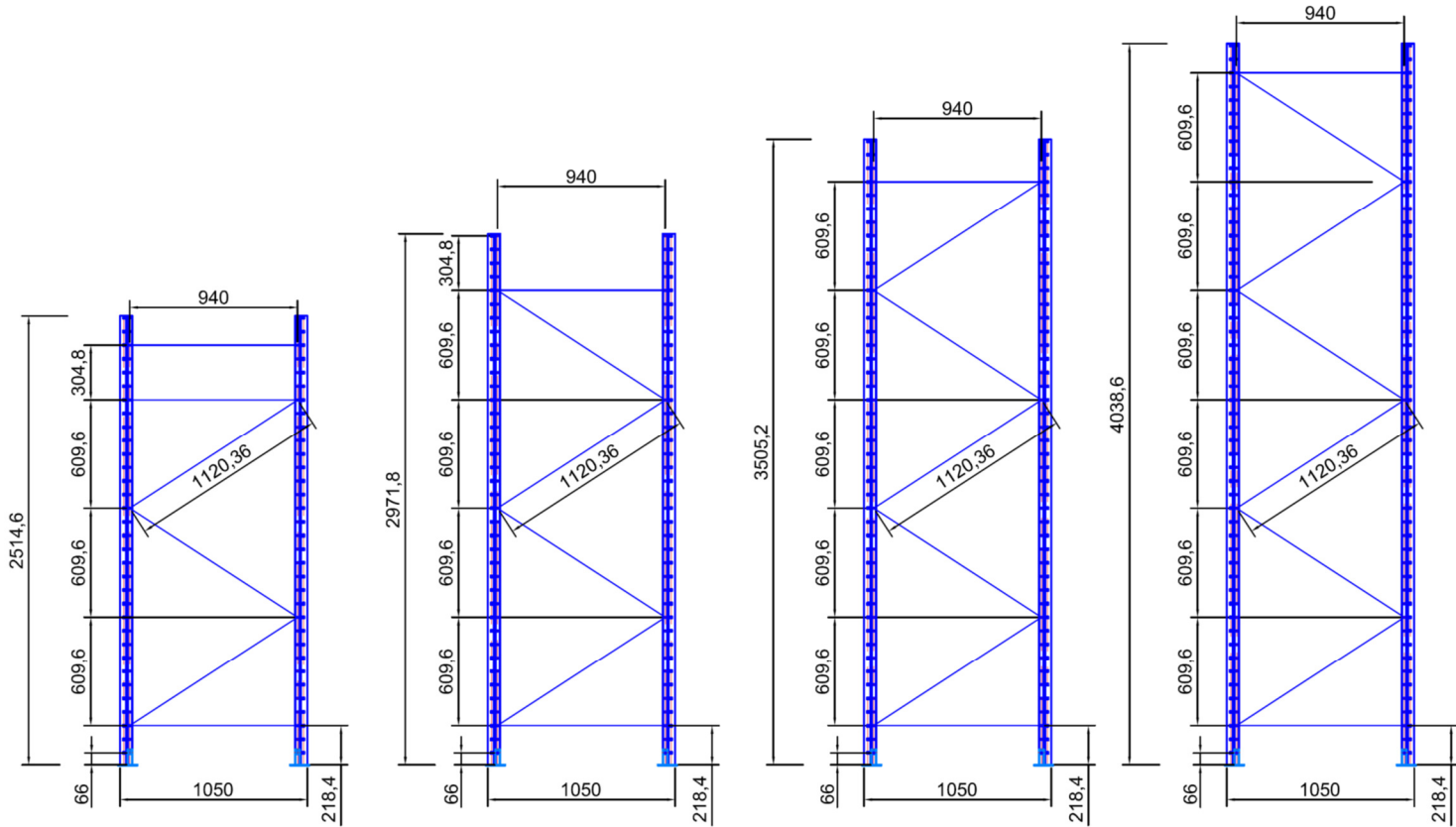

3 H + 3 D

2 H + 4 D

2 H + 5 D

2 H + 6 D

